

G4[TI]

Android Multi-Biometric Facial Recognition and Thermal Image Temperature Detection Terminal

Compatible with



G4[TI] is an upgraded version of the G4[TD] Visible Light Facial Recognition with Temperature Detection Terminal using intelligent engineering facial recognition algorithms and the latest computer vision technology.

Based on the existing firmware and hardware configuration of G4[TD] as well as the mighty computing power and facial recognition algorithm, the terminal integrates a large resolution thermal imaging module with Computer Vision facial recognition system.

G4[TI] supports facial recognition with large capacity and speedy recognition and other authentication methods, including identification with fingerprint, card, and password. G4[TI] improves security performance in all aspects.

G4[TI] adopts touchless recognition technology and new functions, namely body temperature detection and masked individual identification, which significantly reduces the risk of infection that might be caused by contact with any access control equipment. It is also equipped with an ultimate anti-spoofing algorithm for facial recognition against almost all types of fake photos and videos attack.

Through the fast and accurate body temperature measurement and masked individual identification functions, G4[TI] is a perfect choice to help reduce the spread of germs and help prevent infections straightly at each access point of any premises and public areas, such as hospitals, factories, schools, commercial buildings, stations.

If the function mentioned above cannot satisfy customers' needs, we can provide an EDK embedded development kit and adjustment tools. Based on our robust and stable platform, the client's R&D team can quickly develop, integrate, and debug the entire embedded system.

Features



RFID Card
Recognition



Revolutionary SilkID
Fingerprint Sensor



QR Code
Scanning



Temperature
Detection



Mask Detection



Visible Light
Facial Recognition



Android Open
Platform

Body Temperature Detection Specifications

| | |
|----------------------------------|---|
| Preventative Measures | Mask detection / Body temperature detection |
| Temperature Measurement Distance | 50cm ~ 120cm (1.64ft ~ 3.94ft) |
| Temperature Measurement Accuracy | ±0.5°C (±0.9°F) |
| Temperature Measurement Range | 28°C ~ 40°C (82.4°F ~ 104°F) |

Specifications (GL: GL Exclusive Feature)

Capacity

| | |
|-------------|---------|
| User | 10,000 |
| Face | 10,000 |
| Fingerprint | 10,000 |
| ID Card | 10,000 |
| Transaction | 100,000 |

Communication

TCP/IP
USB Host
Wiegand Input
Wiegand Output
Bluetooth, WIFI

Access Control Interface

Lock Relay Output
Exit Button
Alarm Output
Door Sensor
External Bell

Hardware

High Performance Android Industrial CPU
2GB DDR3 RAM
16GB ROM
GL SilkID Fingerprint Sensor (Optional:
QR Code Module)
7-inch Touch Screen, 1280*800 Pixel
2MP Binocular Camera

Standard Functions

ID Card / Work Code / Push
DST / Schedule Bell
Automatic Status Switch
Record Query / Photo ID

Special Functions

Enhanced Visible Light Facial Recognition
Live Face Detection
Live Fingerprint Detection
Multiple Biometric Verification Modes

Optional Functions

GL 13.56MHz IC Card / ICASS Card / HID Card

Compatibility

ZKBioSecurity (Only Access Control)

Additional Info

Algorithms : ZKFace5.6 & ZKFinger 10.0
Working Temperature: 0°C to 50°C
(32°F to 122°F)
Optimum Operating Temperature:
16°C to 35°C (60.8°F to 95°F)
Working Humidity: <90%
Dimensions: 246*120*51 mm (9.69*4.72*2 in)
Facial Recognition Speed: ≤1s
Facial Recognition Distance: 0.5m ~ 3m
Power: DC12V 3A

Configuration

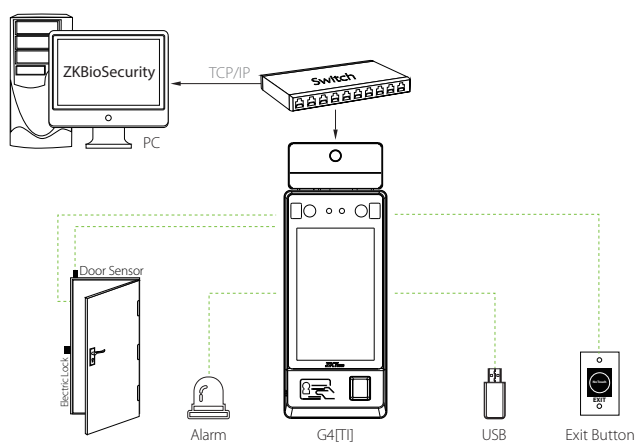

Dimensions (mm)

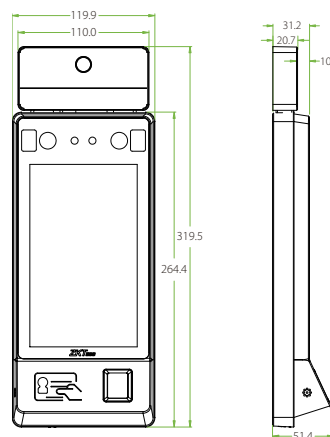

V3.0 2020.11.18

ZKTECO CO.,LTD.

www.zkteco.com

E-mail: sales@zkteco.com



Copyright © 2020 ZKTECO CO., LTD. All rights reserved.